

MEMORANDUM

TO: City Council

FROM: Alfred D. Lott, ICMA-CM, CPM
City Manager

SUBJECT: *Status Report*

DATE: February 22, 2018

Status Report

1. Additional Crosswalk on Belair Drive

Public Works has planned to install a new crosswalk across Belair Drive at the Teal Lane/Stafford Lane intersection. This installation is in response to multiple requests for a crosswalk at this location from residents. This crosswalk is near the High School Annex and will provide another marked crossing to aid pedestrians in walking in that area. Public Works staff has evaluated the location to ensure there is adequate sight distance for safety reasons. A diagram is attached showing location of all current and planned crosswalks on Belair Drive.

2. WSSC Sewer Repairs in Longridge

WSSC recently completed repairs to a sanitary sewer on Linden Lane. (Final street repairs still pend.). WSSC is now carrying out additional sewer replacement and repair work in the Long Ridge area. The remaining work is not in the street, but near Linden Lane. Affected residents on Linden, Long Ridge and Lyric received a notification letter about the work from WSSC on February 9, 2018. A copy of the letter is attached.

ADL/lfr
Attachments



Trinity
(Existing)

Teal-/Stafford
(Proposed)

Tulip Grove
(Existing)

Stonybrook
(Existing)

Beavertown
(Approved, raised crosswalk to be installed by St. Johns)



February 9, 2018

**LONGRIDGE LANE
BOWIE, MD 20715**

RE: Northeast Branch Basin ESA IDIQ, Contract No. CI5302A11 Task Order No. 3

Dear Customer:

Crews working for WSSC will be in your neighborhood soon to **repair** aging sewer manholes and sewer mains as part of our comprehensive sewer rehabilitation program. **Construction of 3 sewer main segments in Continuation of recently completed emergency work are expected to begin on or about February 12, 2018 and be complete by April 27 2018, weather permitting.** Final restoration of sidewalks, roadways and landscaping will take place within 90 days of construction completion **[Projects completed during the winter months will be restored the following spring.]**

Please see the project map on the back to view the streets where work will be taking place. A WSSC inspector will supervise the work, which is being performed by **Ross Contracting, Inc.**

WHAT TO EXPECT

- You may see temporary above-ground (bypass) sewer pipes and pumps, which will be used to move the wastewater around the construction area. You also may hear noise coming from the pumps or nearby generator, which will run 24 hours a day.
- Whenever possible, WSSC works to minimize disruption to roadways and the environment. However, there are projects that require excavation to replace a sewer main. Minimally invasive sewer rehabilitation methods include:
 - **Cured-in-Place Pipe (CIPP):** Involves inserting a liner into the pipe. That liner is expanded and becomes a new pipe. This method uses either steam or Ultra Violet technology to cure the resin, which may on rare occasions produce a distinctive odor at very low levels. Once this process begins, work must continue until the lining is fully cured. Service laterals can generally be reinstated without excavation.
- For additional information regarding the sewer manhole and pipe rehabilitation process, visit: www.wsscwater.com/srm.

IMPACTS

- Anticipated work hours: **Monday-Friday, 7:00 a.m. to 5:00 p.m.** Sewer main rehabilitation can be unpredictable and once some repair processes begin they must be completed that same day. Due to this uncertainty, there may be work vehicles and crews in the project area outside of the normal scheduled working hours.
- WSSC works to minimize impacts to your water service, however, there are occasions when it will be necessary to interrupt your service for up to eight (8) hours.
- There may be temporary changes to traffic patterns and/or parking restrictions. Any vehicles that have not been removed from the area (as denoted by "No Parking" signs) by the time the parking restrictions take effect will be towed to a nearby street at no cost to the owner.
- Directly impacted residents will receive 48-hour advanced notice prior to any water service interruptions or parking restrictions. During parking restriction hours, you will still have access to your home.
- **Please contact the Technical Contract Supervisor if you need special accommodations.**

Washington Suburban Sanitary Commission

CONTACT INFORMATION/QUESTIONS

- On-site WSSC Inspector: Bola Onasanya, 240-495-1329, Abolanle.Onasanya@wsscwater.com
 - WSSC Technical Contract Supervisor: April Wilt, 301-206-4307 or 240-508-1655, April.Wilt@wsscwater.com
- Contact WSSC's 24-Hour Emergency Call Center at 301-206-4002, in the event of a water or sewer emergency.

Affected Areas/Streets Include: [Linden Lane, Lyric Place, Longridge Lane]

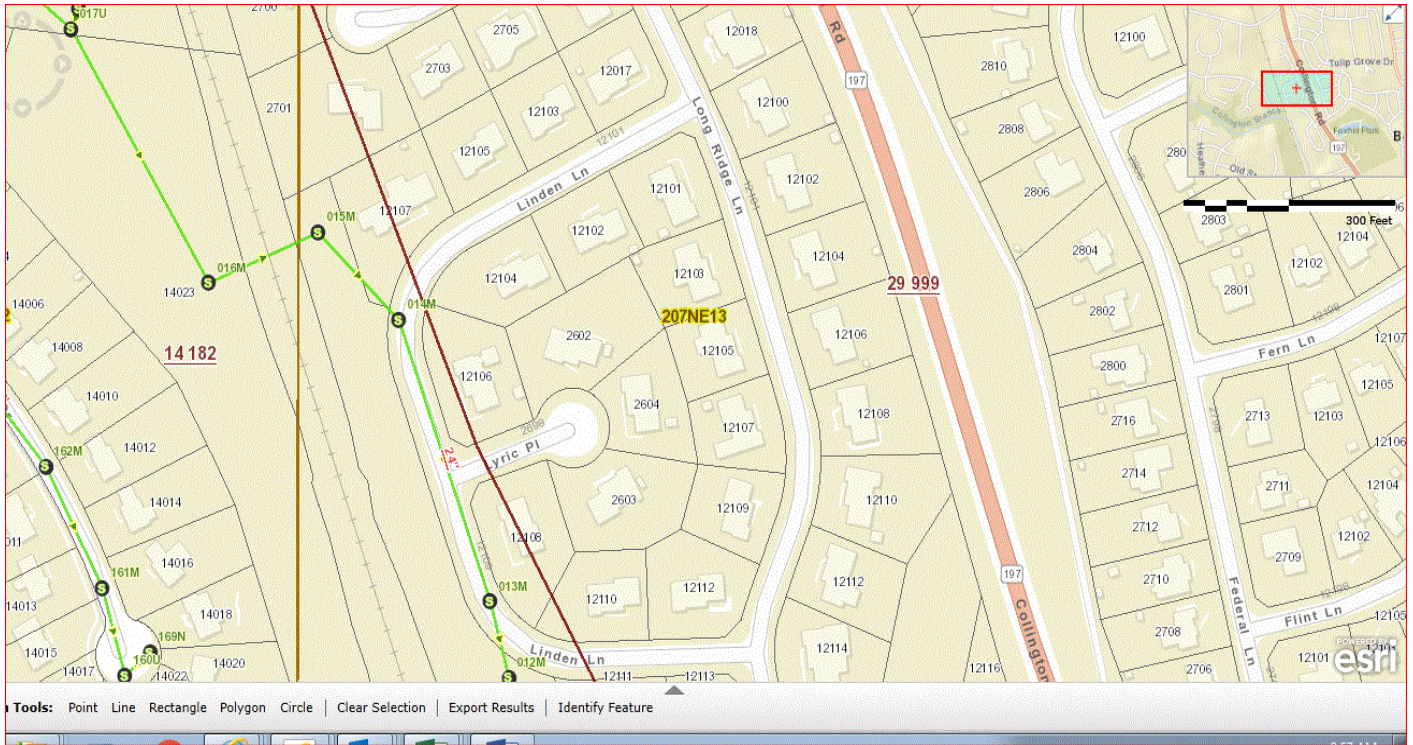

We understand the inconvenience these types of projects can cause and we appreciate your patience as we work to upgrade our infrastructure. You can get additional information about other WSSC Projects online at: <https://gis.wsscwater.com/inyourneighborhood>.