



# City of Bowie

15901 Excalibur Road  
Bowie, Maryland 20716

November 28, 2017

## NOTICE OF STAKEHOLDERS MEETING AND PUBLIC HEARINGS

### Detailed Site Plan

Proposal: Construction of a 389-Unit/5-Story/149,390 Sq. Ft.  
Apartment Building & 5-Level/587-Vehicle Parking Structure

Site Area: 6.62 Acres (of a 25.1-Acre Site)

Current Zoning: M-X-T (Mixed Use – Transportation Oriented)

Location: West Side of Curie Drive, Approximately 850 Ft. North  
of Melford Boulevard

Applicant: St. John Properties, Inc.

Dear Business Owner, Resident or Interested Party:

St. John Properties, Inc. has submitted an application for a Detailed Site Plan for the purpose of constructing a 389-unit/5-story/149,390 sq. ft. residential apartment building in Melford Village. The site of the proposed development is located on the west side of Curie Drive, approximately 850 feet north of Melford Boulevard, and is zoned M-X-T (Mixed Use – Transportation Oriented), where the proposed use is permitted by right under the Prince George's County Zoning Ordinance.

The City has established the following schedule for the Stakeholders Meeting and public hearings for this application:

**STAKEHOLDERS MEETING: Wednesday, December 13, 2017 at 7:00 p.m.**

**BOWIE ADVISORY PLANNING BOARD: Tuesday, January 9, 2018 at 7:00 p.m.**

**BOWIE CITY COUNCIL: Tuesday, January 16, 2018 at 8:00 p.m.**

All of these meetings will be held in the Council Chambers in Bowie City Hall, which is located at 15901 Excalibur Road, Bowie, MD. Your attendance and participation are encouraged at these meetings. In the interim, should you have any questions regarding this project, please do not hesitate to contact me during business hours at 301-809-3047.

Sincerely,

Frank Stevens, AICP  
Department of Planning and  
Economic Development

Attachment (over)

cc: Mr. Robert J. Antonetti, Jr., Shipley and Horne, P.A.  
Mr. Christopher Rizzi, PLA, ASLA, Bohler Engineering, PC  
Mr. Andrew Roud, St. John Properties, Inc.

t:/stakeholdersmeeting&publichearingnotice.doc

**MAYOR** G. Frederick Robinson **MAYOR PRO TEM** Henri Gardner

**COUNCIL** Michael P. Estève ♦ Courtney D. Glass ♦ James L. Marcos ♦ Diane M. Polangin ♦ Isaac C. Trough **CITY MANAGER** Alfred D. Lott  
City Hall (301) 262-6200 FAX (301) 809-2302 TDD (301) 262-5013 WEB www.cityofbowie.org

U.S.

U.S. Rt. 301

CORPORATE LIMITS

To Washington, D.C.

U.S. Rt. 50/301

To Annapolis

HWY

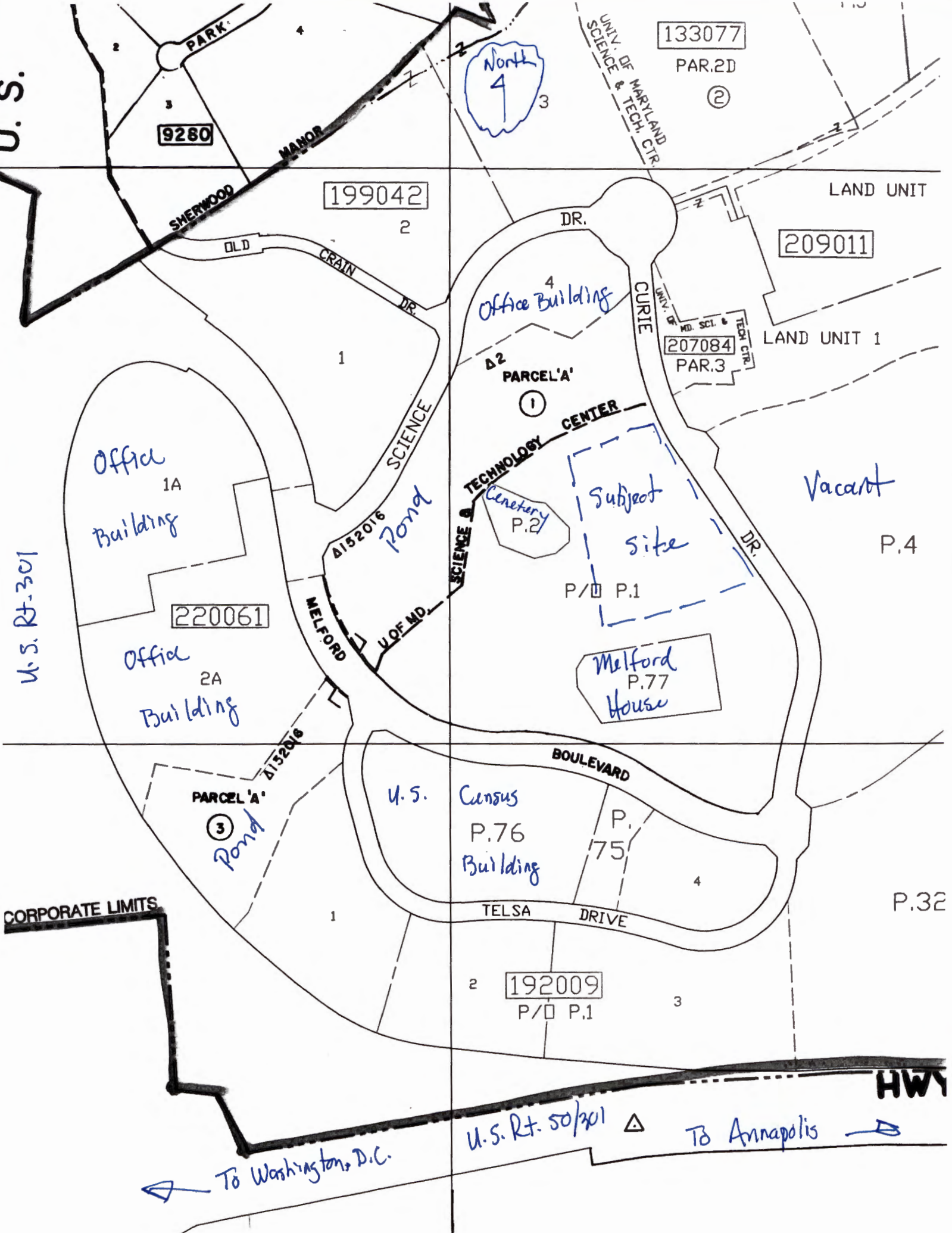

9280

199042

133077

PAR.2D

(2)

LAND UNIT

209011

LAND UNIT 1

207084

PAR.3

PARCEL 'A'

(1)

Vacant

P.4

Office Building 1A

Office Building 2A

220061

SCIENCE & TECHNOLOGY CENTER

Cemetery P.21

Subject site

Melford House P.77

U.S. Census Building P.76

P.75

PARCEL 'A'

(3)

Pond

TELSA DRIVE

192009

P/□ P.1

P.32